

The D2000 world series swivel joint is the ultimate in swivel joint technology, specifically designed for the petroleum, chemical, compressed gas, food, and bulk powder industry.

"DESIGNED FOR LONG LIFE AND EASE OF OPERATION"

- Heavy duty dual split flange design
- 5 year limited warranty
- Low Profile to reduce overall height and bend radius
- Ultra low maintenance
 - No field greasing required for five years
 - Simply unbolt either of the flanges to remove seal
 - No ball bearings to remove
- Available in 2", 3", 4", & 6"



"MADE FOR TOUGH APPLICATIONS"

Bearing module is removed from the liquid path for outstanding performance with aggressive chemicals

"Deep Groove" ball bearing technology provides "best in class" load carrying capacity

Seal options:

- Spring energized lip seal
- H-Block PTFE carrier seal with an extensive range of O-Ring elastomers

Removable flanges can be made from many materials

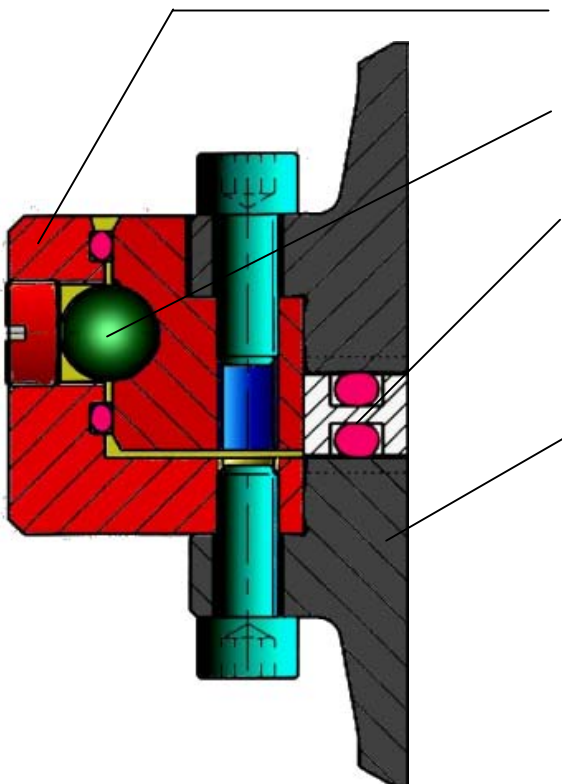

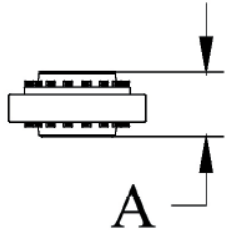

Size	A Dimension	Weight
2"	3.86"	12.5 lbs
3"	3.86"	16.0 lbs
4"	3.86"	21.0 lbs
6"	6.29"	74.0 lbs



SEAL OPTIONS

- BUNA H-BLOCK
- EPDM H-BLOCK
- VITON H-BLOCK
- PTFE H-BLOCK
- PTFE LIP SEAL
- FLUOROLOY K LIP SEAL

GREASE OPTIONS

- STANDARD (CHEVRON DURALITH)
- HIGH TEMP (DOW CORNING 44)
- LOW TEMP (DOW CORNING 33)
- FOOD GRADE (BEL-RAY NO TOX)
- CHEMICAL GRADE (DOW CORNING 3451)

FLANGE OPTIONS

- 304 STAINLESS STEEL
- 316L STAINLESS STEEL
- ALLOY 20
- ALUMINUM
- CARBON STEEL
- DUPLEX STAINLESS
- LOW TEMP CARBON STEEL
- MONEL

NEW PART NUMBERS! In order to create some uniformity with our swivel joint part numbers, we have developed a numbering system that corresponds with steps 1-7 above. The illustration below shows how to build the part #.

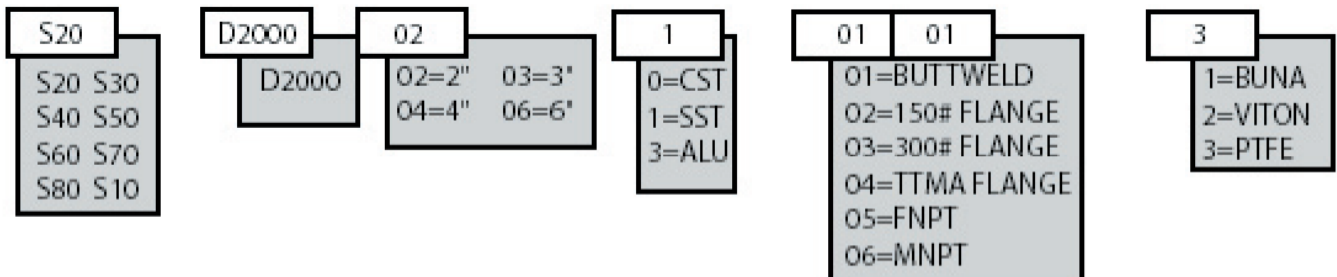

EMCO WHEATON
 A Gardner Denver Company

Whilst the content of this leaflet has been edited with the greatest care, we are not liable for any errors or omissions

EMCO WHEATON
 USA Inc

9111 Jackrabbit Road
 Houston Texas
 USA
 77095
 PO BOX 691247
 Phone: +1-281/856-1300
 Fax: +1-281/856-1325
sales@us.emcowheaton.com
www.emcowheaton.com