

# Specification Sheet Openable API Adaptor

## FEATURES AND BENEFITS

An API adaptor with a one-piece body, hard anodised indexable nose ring, flat bottom and product indicator. These valves set new standards in terms of design features and build quality against which others will be judged.

- **Hard anodised** replaceable nose ring that can be indexed through four positions for extended life.
- **Flat bottom** of valve body ensures complete product drainage and minimises contamination.
- **Product sight glass** fitted at lowest point of valve for visual check of product in pipe-work.
- **Two stage** fixed aluminium handle gives positive indication of valve position.
- **Conforms** to API RP1004 for total compatibility with API couplers.
- **Lightweight** die cast aluminium construction for increased payloads with strength.
- **Viton seals** are standard for compatibility with high-octane fuels and additives.
- **Hydrodynamic** design minimises pressure drop for high flow rates.
- **Stainless steel** operating shaft, cam and poppet stem for durability.
- **Top mounting** for hose interlock.

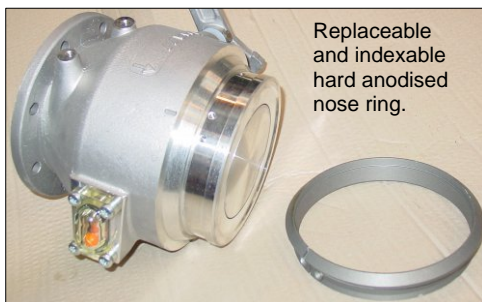

**WEIGHT** 4.45Kg

## APPROVALS

- API RP1004
- CEN



When specifying Openable API Adaptors for your vehicle the following points should be considered:

- Remember to specify F0567 API Hose Interlocks if they are required.
- How many valves are required per vehicle?
- Specify F5001 if sightglass is not required.
- Remember to specify the F0499 API Dust Cap to protect your valves.
- Remember to order the flange gasket (000610611 cork or 00603672 fibre) to suit this valve.
- Steel mating flange is also available (00446700).